

LEVER HOISTS



Lightweight, portable, chain type lever operated puller. Increases a worker's efficiency in pulling, lifting, lowering, moving and skidding objects in industrial maintenance, construction and utility company applications. Minimal effort is required to move tons. The short handle and short stroke are designed to operate in tight places. Excellent for stretching cable and fencing, positioning machinery and building components.

Construction Features:

Frame/Side Plate: Rugged, lightweight steel design supports and protects internal mechanism.

Lever/Lever Block: Designed and constructed to be easily operated by one person. Helps absorb the shock of the load. Can be easily disassembled for maintenance.

Operation: Two levers and a knob control the operation of the ACCOLIFT® Lever Hoist. The lifting "lock" lever can only be engaged when the hoist chain is slack (not under load). The grip ring is then pulled to engage the load sheave. Choose "Up" or "Down" position on the handle to raise or lower the load.

Gears: Six tooth pinion gear and four pocket load sheave makes operation easy. Gears are permanently lubricated.

Mechanical Load Brake: Brake can hold a full capacity load stationary in any position. Load is not transferred back to handle during handle advancement.

Load Chain: Electric welded alloy steel chain is heat treated for wear resistance and strength. Accurately and uniformly sized to seat properly in load sheaves.

Load Block: Supports the suspension hook and allows it to rotate 360° under capacity loads.

Hooks: All hooks are drop forged, heat treated steel with spring type latches. Both hooks rotate 360° for easy rigging.

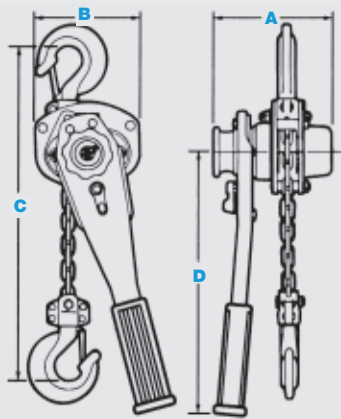

For hook dimensions, see page 26.

| Model Number | Cap. (Tons) | Std. Lift (ft.) | Pull to Lift Full Load (lbs.) | Dimensions (in.) | | | | Load Chain Diameter (in.) X Chain Fall Lines | Weight for Add'l 1 ft. of lift (lbs.) | Net Weight (lbs.) |
|--------------|-------------|-----------------|-------------------------------|------------------|-----|------|------|--|---------------------------------------|-------------------|
| | | | | A | B | C | D | | | |
| 1150010 | 3/4 | 5 | 35 | 5.9 | 5.0 | 11.4 | 9.4 | .248 X (1) | 0.6 | 16 |
| 1150110 | 3/4 | 10 | 35 | 5.9 | 5.0 | 11.4 | 9.4 | .248 X (1) | 0.6 | 19 |
| 1150210 | 3/4 | 15 | 35 | 5.9 | 5.0 | 11.4 | 9.4 | .248 X (1) | 0.6 | 22 |
| 1150020 | 1-1/2 | 5 | 40 | 6.5 | 5.8 | 13.4 | 14.2 | .280 X (1) | 0.8 | 22 |
| 1150120 | 1-1/2 | 10 | 40 | 6.5 | 5.8 | 13.4 | 14.2 | .280 X (1) | 0.8 | 26 |
| 1150220 | 1-1/2 | 15 | 40 | 6.5 | 5.8 | 13.4 | 14.2 | .280 X (1) | 0.8 | 30 |
| 1150030 | 3 | 5 | 73 | 7.6 | 7.1 | 16.9 | 14.2 | .354 X (1) | 1.2 | 36 |
| 1150040 | 6 | 5 | 77 | 7.6 | 7.1 | 22.4 | 14.2 | .354 X (2) | 2.4 | 60 |

Authorized Sales & Service
J. HERBERT CORPORATION
 Call 1-800-255-0588
 407-846-0588 Fax: 846-1066
 info@jherbertcorp.com
 Visit us online:
 www.jherbertcorp.com

HOOK DIMENSIONS

Authorized Sales & Service
J. HERBERT CORPORATION
 Call 1-800-255-0588
 407-846-0588 Fax: 846-1066
 info@jherbertcorp.com
 Visit us online:
 www.jherbertcorp.com

HAND CHAIN HOISTS - HOOK DIMENSIONS:

| Capacity | A | B | C | D | E |
|----------|------|------|------|------|------|
| 1/2 Ton | 0.62 | 2.87 | 0.79 | 1.42 | 1.22 |
| 1 Ton | 0.81 | 3.38 | 0.94 | 1.57 | 1.34 |
| 2 Ton | 0.94 | 4.45 | 1.18 | 1.97 | 1.61 |
| 3 Ton | 1.10 | 5.24 | 1.65 | 2.13 | 1.77 |
| 5 Ton | 1.50 | 5.98 | 1.81 | 2.40 | 1.97 |
| 10 Ton | 2.44 | 9.29 | 3.54 | 3.27 | 2.40 |

LEVER HOISTS - HOOK DIMENSIONS:

| Capacity | A | B | C | D | E |
|-----------|------|------|------|------|------|
| 3/4 Ton | 0.67 | 3.15 | 0.87 | 1.48 | 1.22 |
| 1 1/2 Ton | 0.95 | 3.86 | 1.10 | 1.81 | 1.50 |
| 3 Ton | 1.10 | 5.24 | 1.65 | 2.13 | 1.77 |
| 6 Ton | 1.50 | 5.98 | 1.81 | 2.40 | 1.97 |

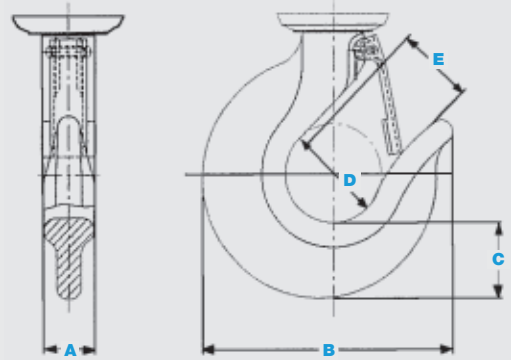

OPTIONS FOR HAND CHAIN HOISTS

Bronze wheels, nickel plated trolley and hoist body, nickel plated hand and load chain, bronze coated hook and load block.



Bronze wheels, bronze load hook and stainless steel load chain.



Stainless steel load chain, bottom block and hook.



Chain container.

